



SG211 SprinkGUARD w/ SprinkLOCK Plate Installation Guide

The SG211 SprinkGUARD w/ SprinkLOCK plate is made to accommodate various supply lines and fitting sizes as well as existing water shields. When attached to the SG211, the adjustable SprinkLOCK plate helps prevent the guard from rotating on the supply line and causing potential damage to the sprinkler head. For correct installation of the SG211, follow the listed steps below.

STEP 1: Identify all items needed for the installation of one guard.

Items Include:

- (1) SG211 SprinkGUARD
- (1) SG905 SprinkLOCK
- (2) U bolts (specific for line size)
- (6) 1/4" Nylock Nuts
- (2) 1/4" x 3/4" Hex Bolts

Installer will need a 7/16" wrench and socket for the installation.

NOTE: Where there is an existing water shield, move to **STEP 3**

STEP 2: Prior to installing the SG211 on the supply line, preassemble the SprinkLOCK plate onto the SG211 using the provided 1/4" x 3/4" hex bolts and nylock nuts.

STEP 3: Carefully place SprinkGUARD assembly over the sprinkler head needing protection, secure assembly to the supply line using (2) U bolts (4) 1/4" Nylock Nuts while making sure to center the cage on the sprinkler head. If there is an existing water shield, you can now loosely install the SG905 SprinkLOCK plate with (2) 1/4" x 3/4" Hex Bolts and (2) 1/4" Nylock Nuts.

STEP 4: Once SprinkGUARD assembly is centered and secured on supply line, proceed to slide SprinkLOCK plate forward until it makes contact with fitting, i.e. Weld-o-let or threaded T. While holding SprinkLOCK in place, tighten the 1/4" x 3/4" bolts to secure SprinkLOCK on the fitting.

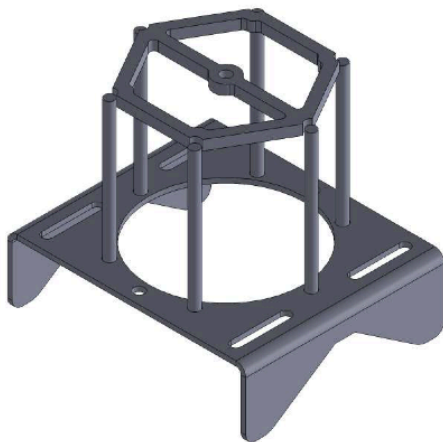

SG211 SprinkGUARD



SG905 SprinkLOCK